

## FLOW-24 LAMINAR FLOW CABINET



### TECHNICAL SPECIFICATION

Airflow	Vertical downflow; 0.3 m/s - 0.45 m/s (60 - 90 fpm)
Pre-Filter	Disposable polyester fibers with 85% arrestance
Main Filter	HEPA efficiency, 99.99% at 0.3µm
Clamping	Screw compression clamp
Electrical	120V, 60Hz or 230V, 50Hz voltages available. Specify when ordering. Other voltage options available.
Power Consumption	22 watt
Lighting	LED

### DIMENSIONS

Nominal Width	610 mm
Internal Height	610 mm
Internal Depth	610 mm
External (W x D x H)	610 x 610 x 889 mm
Shipping (W x D x H)	1016 x 1016 x 1143 mm
Weight	33 kg

### DESCRIPTION

Purair® FLOW Series laminar flow cabinets are designed to protect the interior work zone from biological or particulate contamination.

It is ideal for pharmacy compounding of non-toxic agents, assembly of finely tuned instrumentation, cell culture and other processes where protection of the user is not required but easy access to the work surface is important.

ISO Class 5 air quality is maintained through a downward laminar flow that provides gentle airflow throughout the cabinet. The clean, simple, low maintenance design offers a comfortable workstation for a range of applications and may be bench mounted or positioned on a mobile bench.

### FILTRATION

At the heart of the Purair product line is innovative filtration technology. The Multiplex Filtration System consists of a pre-filter and main filter. The mechanical design enhances safety, convenience and overall value.

- The disposable pre-filter is accessible from the exterior top of the cabinet.
- A filter clamping mechanism allows for the filter to be easily installed and ensures an even seal at the filter peripheral face at all times to prevent bypass leakage.
- The filter chamber prevents contaminated air from contacting internal cabinet mechanisms.

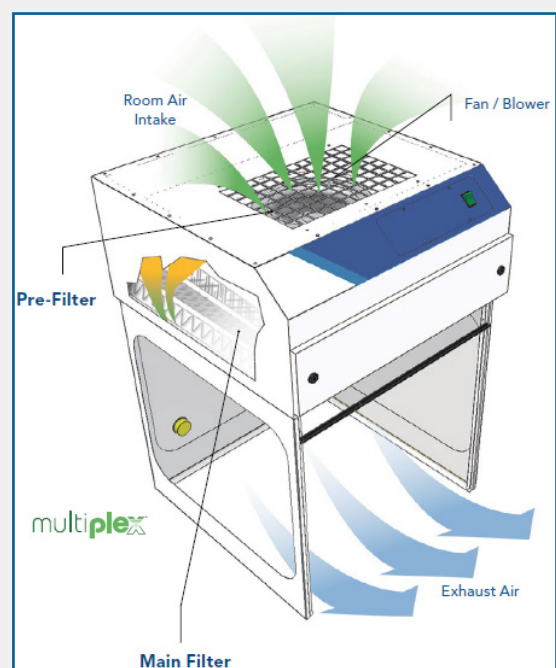

AES OFFER INSTALLATION AND SERVICE SUPPORT FOR ALL EQUIPMENT

## FLOW-24 LAMINAR FLOW CABINET

### KEY FEATURES

- Provides sterile work zone for aseptic techniques.
- Air cleanliness meets ISO Class 5.
- Energy saving LED lighting.
- Vertical laminar flow with HEPA filtration.
- Large front opening provides unrestricted access to the work zone.

### PRODUCT FEATURES

**A. Control Panel:** The control panel includes an On/Off switch for simple operation.

**B. Main Filter:** HEPA filter with 99.99% efficiency for 0.3 micron particulates (ULPA optional).

**C. Pre-Filter:** Disposable polyester fiber pre-filter with 85% arrestance.

**D. Blower Motor:** Centrifugal fan.

**E. Stand:** Optional base stand converts to mobile cart with optional locking casters

**F. Lighting:** Compact LED cabinet lamp located away from laminar flow area.

**G. Pass Through Ports:** Convenient rear-wall pass through ports for safe routing of instrument cords, cables, and leads.

**H. Filter Door Lock:** Prevents unauthorized removal or accidental exposure to saturated filters.

**I. Filter Clamp:** Wide knob filter clamps are conveniently located forward of the assembly. The clamps secure the filter to the plenum with even pressure to assure a tight seal and to simplify filter removal and replacement when required.

**J. Work Surface:** Optional polypropylene spill tray, available in white or black, or optional stainless steel spill tray available.



### ADDITIONAL FEATURES

**360 Degree Visibility:** Clear back and side panels allow ambient illumination into the chamber and provide users with an unobstructed view of its contents.

**Construction:** All models are available in either metal or polypropylene construction, specify when ordering. Available in 120V, 60Hz or 230V, 50Hz models.

### SELECTION

Purair FLOW cabinets are available in three model sizes with various options. Designed for desktop use, or for installation on an optional base stand or mobile cart.

AES OFFER INSTALLATION AND SERVICE SUPPORT FOR ALL EQUIPMENT

## FLOW-24 LAMINAR FLOW CABINET



### CABINET CONTROL

The basic control panel features an On/Off switch for simple operation of the blower and light.

### PERFORMANCE

The Multiplex filter offers a range of options for high performance protection.

Multiplex filter configuration permits a customized combination of filter media for a broad range of chemical families and biological agents if required.

Purair FLOW cabinets maintain up to 0.45 m/s (90 fpm) airflow velocity, measured 6" (150 mm) from the filter face.

The HEPA filters are easy to replace; no tools required.

### RELIABILITY

Purair FLOW cabinets incorporate energy-efficient centrifugal blowers for maximum operational savings, low noise and minimal vibration.

Long-life HEPA filters without aluminum separators are used to increase filter efficiency, minimize the potential for leakage and increase filter life.

### DESIGN

Professional quality cabinets comply with current technical and safety regulations.

The cabinet frame and work surfaces, comprised of industrial components, are durable and chemically resistant with a microbial powder finish coating.

The filter assembly is easy to access, easy to change, plus a unique filter clamping design eliminates bypass leakage of the main filter.

Stackable sections make cabinets highly portable and enable quick setup.



FLOW-24, shown with optional spill tray and mobile cart.

### OPTIONS & ACCESSORIES

- **ULPA Filter:** ULPA filter efficiency 99.999% at particle sizes between 0.1 to 0.3µm.
- **Spill Tray (Polypropylene):** Removable for easy cleaning.
- **Spill Tray (Stainless Steel):** Removable for easy cleaning.
- **Base Stand, Mobile, with Casters:** Provides a lower storage shelf; accommodates wheelchair access. Locking casters fix the hood in place.
- **Base Cabinet, Fixed (Metal):** Provides storage space below.
- **Base Cabinet, Fixed (Polypropylene):** Provides storage space below.
- **Fire Safety Cabinet Base:** Flame resistant safe storage for combustible and flammable liquids.
- **Polypropylene Construction:** Cabinets are available in all polypropylene construction.

If you would like to configure your Laminar Flow Hood with these options please contact AES.

AES OFFER INSTALLATION AND SERVICE SUPPORT FOR ALL EQUIPMENT