

AIR SCIENCE SAFESTORE FILTERED / VENTED STORAGE CABINETS



Model shown - 34S

DESCRIPTION

Safestore™ Vented Chemical Storage Cabinets are useful for storage of noxious or odorous chemicals. These cabinets minimize health and environmental risks in handling chemical vapours and residues, VOCs and general laboratory functions.

The Air Science® Multiplex™ Filtration System protects the safety of personnel during use, maintenance and decontamination.

Environmental Benefits. Air Science Safestore Vented Chemical Storage Cabinets isolate and trap chemical vapors to prevent ecological impact through release into the environment.

Versatile. Each filtration system is selected for its specific application. Carbon filters are available in various configurations for use with vapors of organic solvents, acids, mercury and formaldehyde. HEPA/ULPA filters can be added for biological safety.

Easy to Install. The vented chemical storage cabinet is self-contained and does not require venting to the outside. Units can be moved with minimal downtime and without filter changes. Set-up, operation and filter maintenance are straightforward.

Energy Efficient. Because filtered air is returned to the room, no demands are required of the facility HVAC capacity for make-up air.

Cost Effective. Facility ductwork, HVAC and construction costs are eliminated.

Safe to Use. Cabinet airflow and face velocity protect users from incidental exposures to fumes.

FEATURES

- Activated carbon main filter formulated for general purpose storage to contain putrid organic odors as well as fumes (i.e. alcohol, solvents, gasoline, etc.).
- Perforated polypropylene shelves.
- With optional HEPA filter, eliminates exposure to biological particulates.
- Upflow airflow geometry operates at 0.6 - 0.9 m/sec face velocity to exchange air through activated carbon main filter.

AES OFFER INSTALLATION AND SERVICE SUPPORT FOR ALL EQUIPMENT

AIR SCIENCE SAFESTORE FILTERED / VENTED STORAGE CABINETS



A. Control Panel: Electronic controls and displays include switches for the blower and lights and low airflow alarm, all located on a convenient front surface panel.

B. Airflow Alarm: A continuous air velocity monitoring system alerts the operator upon unacceptable values.

C. Dynamic Filtration Chamber: The dynamic filter chamber prevents any possible leakage of contaminated air by pressurizing the fan plenum (positive air) and depressuring the filter compartment (negative air).

D. Filter: Includes carbon filter. Optional HEPA filter available; see Options & Accessories.

E. Construction: The standard size and tall cabinets feature all polypropylene construction.

FILTRATION

The Multiplex feature permits one or more filtration options to be combined to meet a wider range of multiple-use applications.

The vented chemical storage cabinet can be equipped with a single activated carbon main filter or with a stacked configuration which combines two main filters, each activated to adsorb one or more specific vapors or family of vapors. For safety against particulates, an optional HEPA or ULPA can also be added.

The carbon filter is sized to fit the specified product model number and configured to optimize airflow across 100% of the filter surface area. The self-contained assembly maximizes filter efficiency, prolongs filter life, optimizes diffusion and saturation and improves user safety.

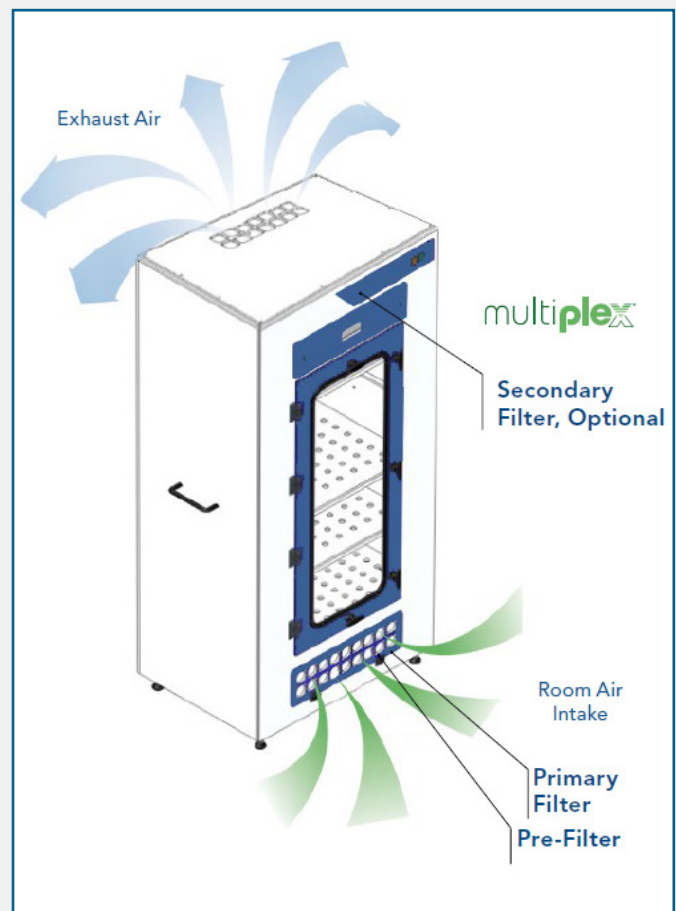

AES OFFER INSTALLATION AND SERVICE SUPPORT FOR ALL EQUIPMENT

AIR SCIENCE SAFESTORE FILTERED / VENTED STORAGE CABINETS

MULTIPLEX FILTRATION SYSTEM, SUMMARY

Application	Chemical	Powder/ Biological	Chemical & Powder	Chemical within Cleanroom
Secondary/ Stacked Filter, Optional	C	H	C	H
Primary Filter	C	H	H	C
Pre-Filter	P	P	P	P

The system can be configured for the capture of acids, bases and particulates, such as biological aerosols, when paired with HEPA or ULPA filters.

P. Electrostatic Pre-Filter: Protects the main filters from aerosols, mists, dust and particulates.

C. Activated Carbon Main Filter: A single, blended or stacked filter configuration.

H. HEPA/ULPA Filter, Optional: Both HEPA and ULPA filters use micro-glass fiber media designed to capture fine particles and biologicals. Both filters can capture particles smaller than the micron size for which they are tested. HEPA and ULPA filter efficiencies are 99.995% at 0.3 microns and 99.9995% at 0.12 microns respectively.



TECHNICAL SPECIFICATIONS

Model	Internal Height	External (W x D x H)	Net	Ship
34S	470 mm	864 x 508 x 740 mm	55 kg	80 kg
34T	1245 mm	864 x 610 x 1800 mm	104 kg	124 kg
64T	1245 mm	1626 x 610 x 1800 mm	266 kg	276 kg

Model	34S	34T 64T
Finish	Polypropylene	
Electrical	230V, 50Hz	
Monitoring	Low airflow	
Lighting	2 vertical mount high intensity LED	
Door	Sliding	Hinged, keylocked

AES OFFER INSTALLATION AND SERVICE SUPPORT FOR ALL EQUIPMENT

REVISION HISTORY				
ZONE	REV	DESCRIPTION	DATE	APPROVED
RIGHT SIDE	1	HOLE POWER INLET	2/3/2017	P CH
RIGHT SIDE	2	HOLE FOR CONTROL PANEL	8/25/2017	P CH
TOP COVER	3	NEW AIRFLOW HOLES	9/11/2018	P CH

- NOTES:
 1.0 CUSTOMER:
 2.0 SUMIT DRAWING FOR APPROVAL.
 3.0 CONSTRUCTION:
 3.1 BODY BUILD IN WELDED PP 3/8".
 3.2 FRONT METAL DOOR WITH TEMPERED GLASS.
 4.0 REMOVABLE POLYPRO SHELVES IQUAL SPACING BETWEEN SHELVES.
 5.0 POWER INLET 120 V 60 HZ
 6.0 FSA ALARM SYSTEM.
 7.0 STANDARD FEATURES APPLIED.
 8.0 W/O

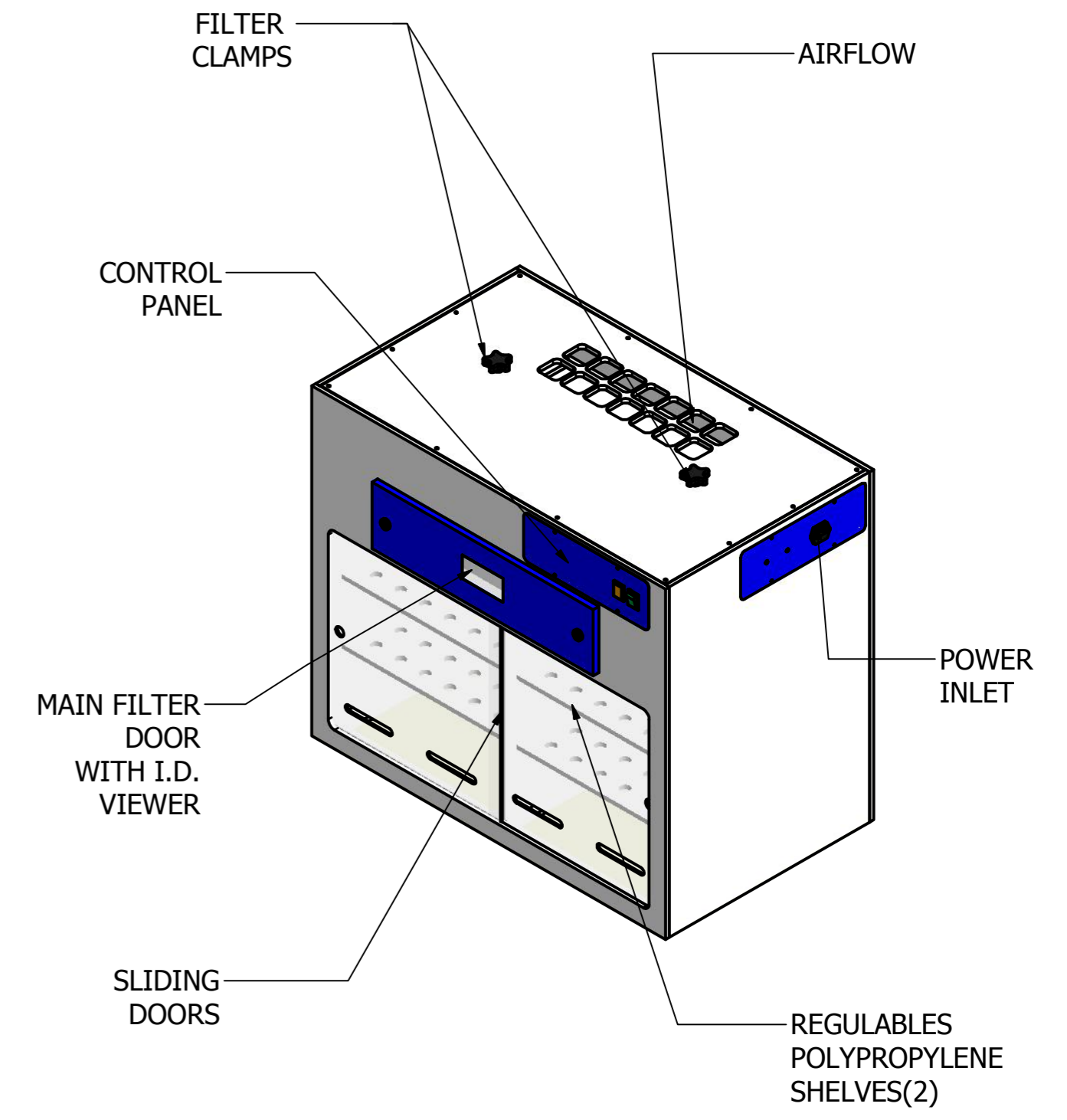
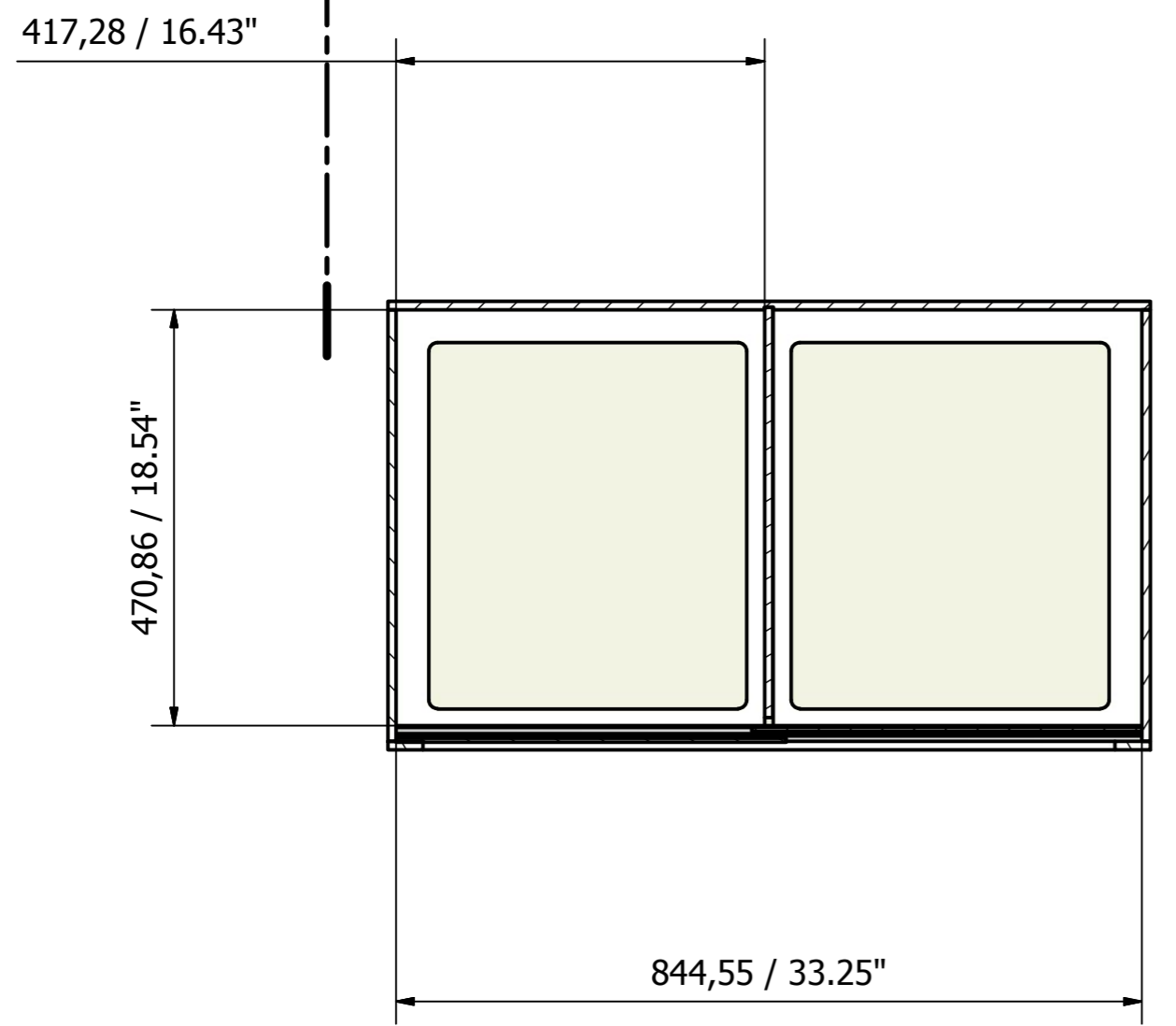
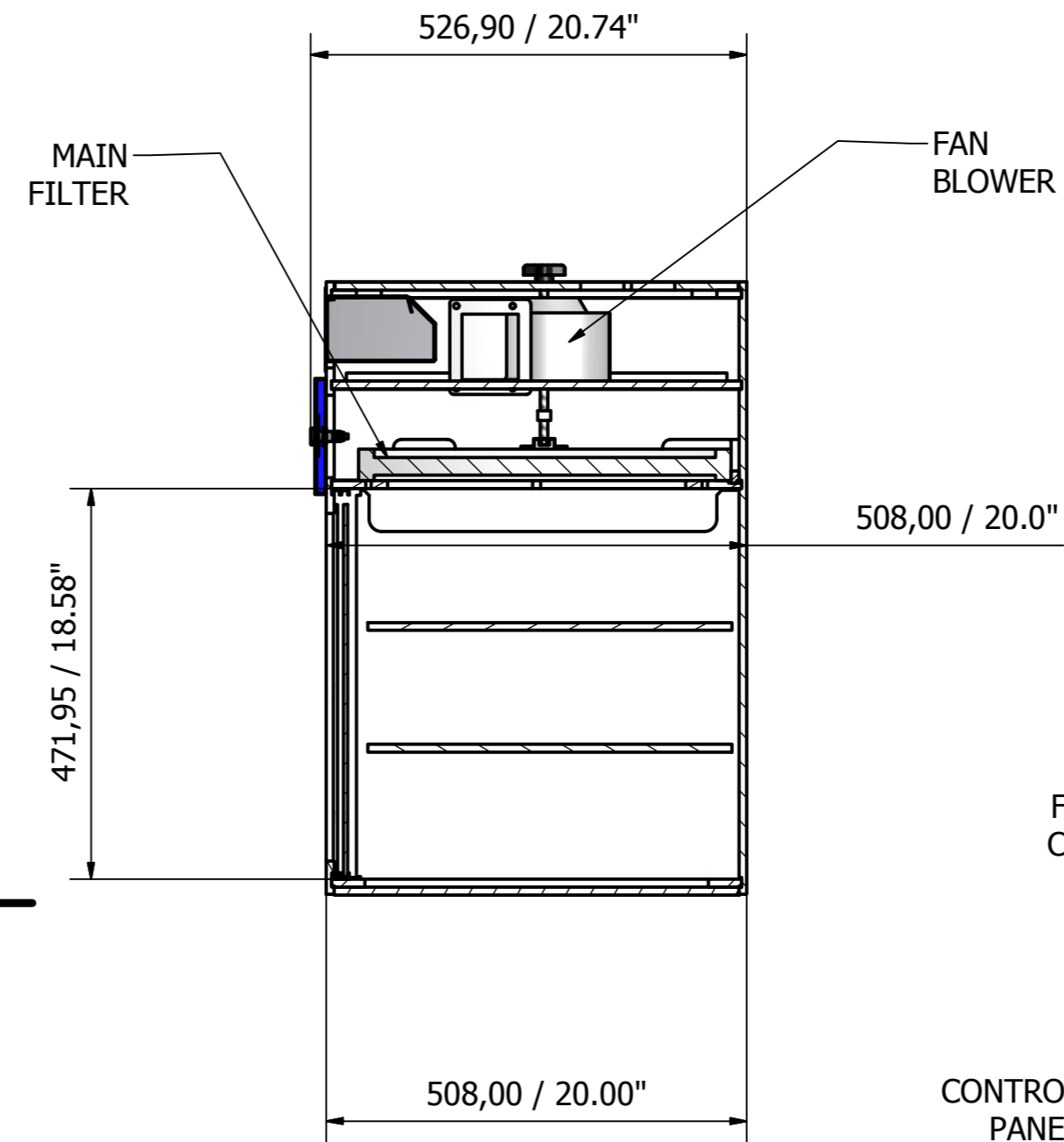
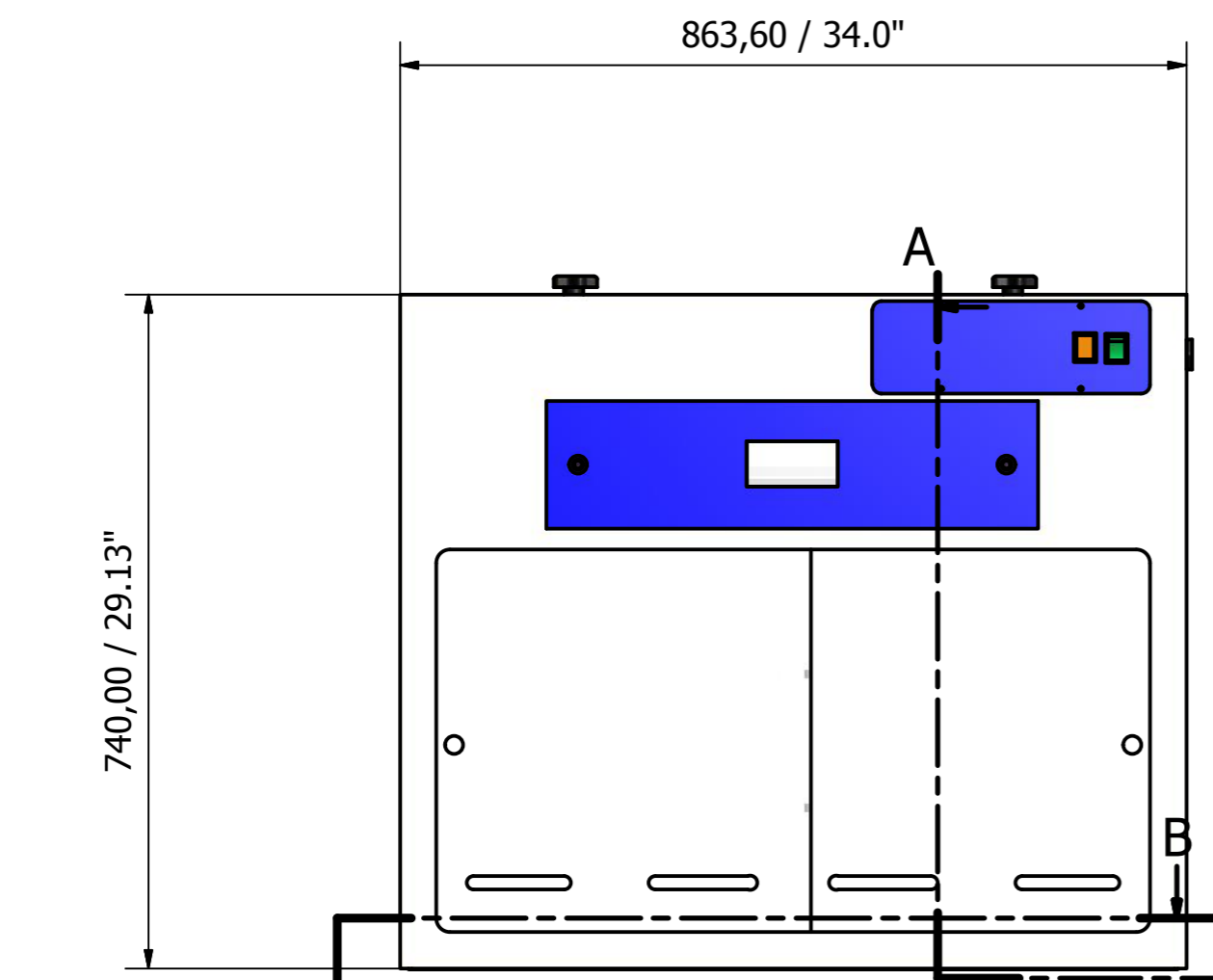

A-A (1 : 8)

B-B (1 : 8)

Designed by CG	Checked by	Approved by	Date 12/3/2013	Date
AIR SCIENCE USA		SAFESTORE 34S CABINET		
SC34S-GAssem		Edition 3	Sheet 1 / 1	

REVISION HISTORY				
ZONE	REV	DESCRIPTION	DATE	APPROVED
RIGHT SIDE	1	HOLE POWER INLET	2/3/2017	P CH
RIGHT SIDE	2	HOLE FOR CONTROL PANEL	8/23/2017	P CH

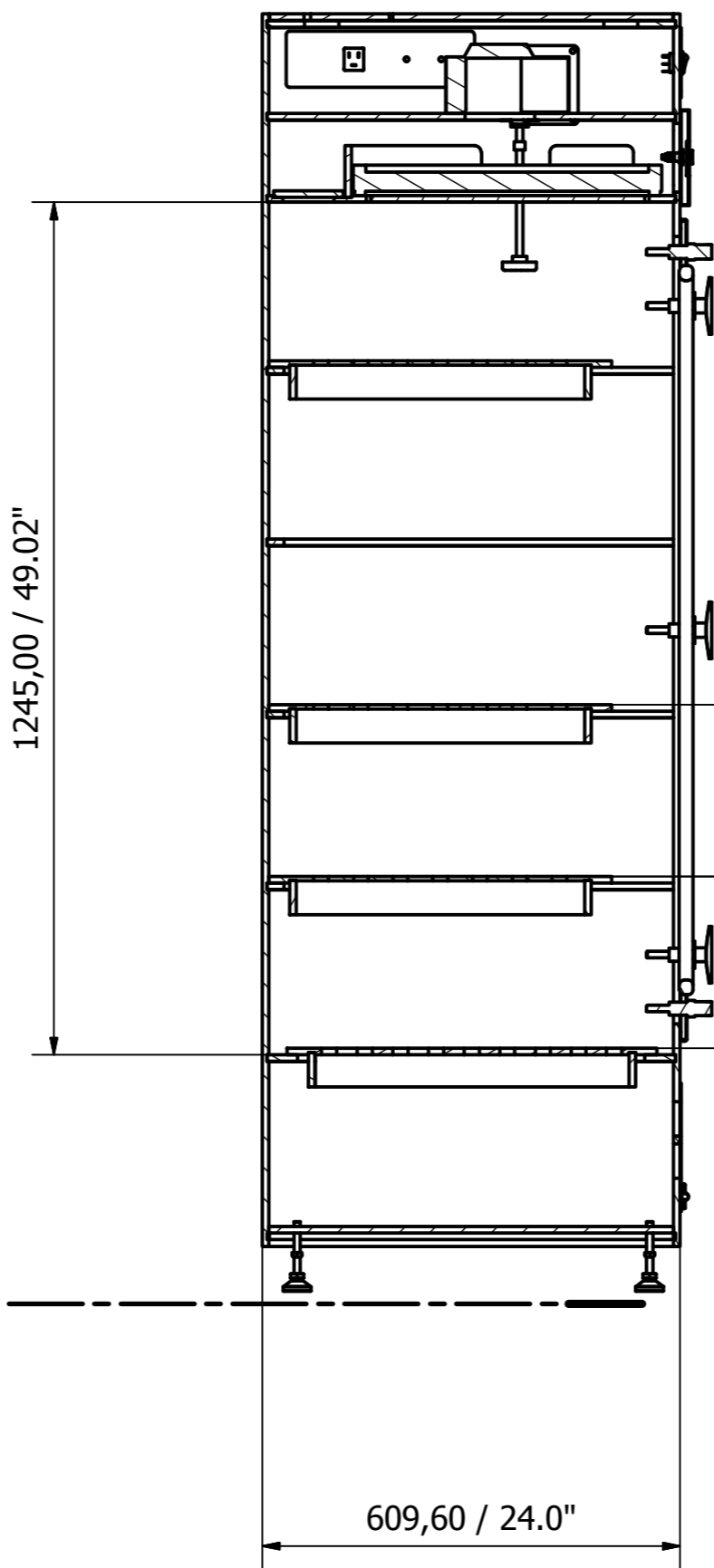
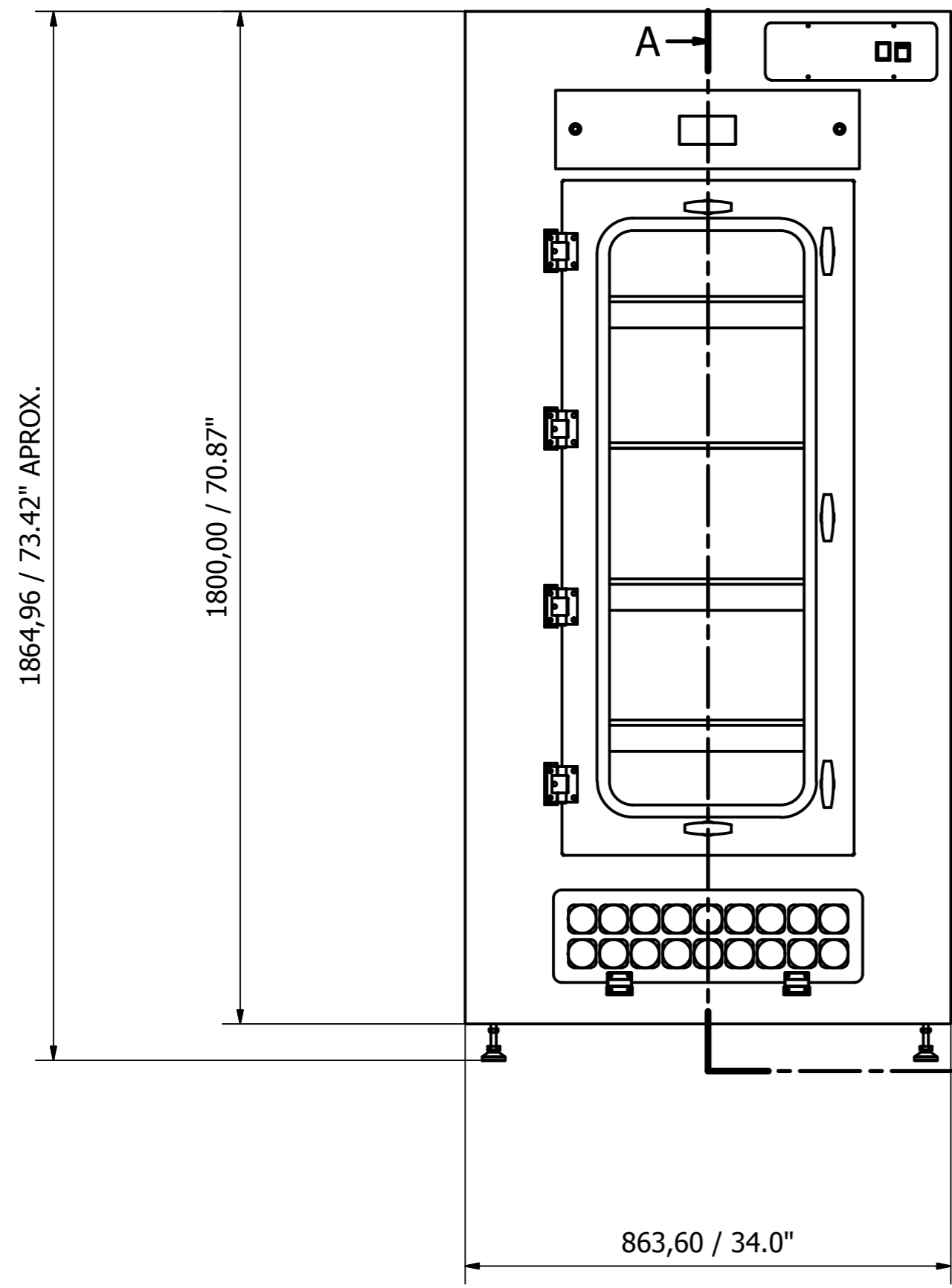

A-A (0.10 : 1)

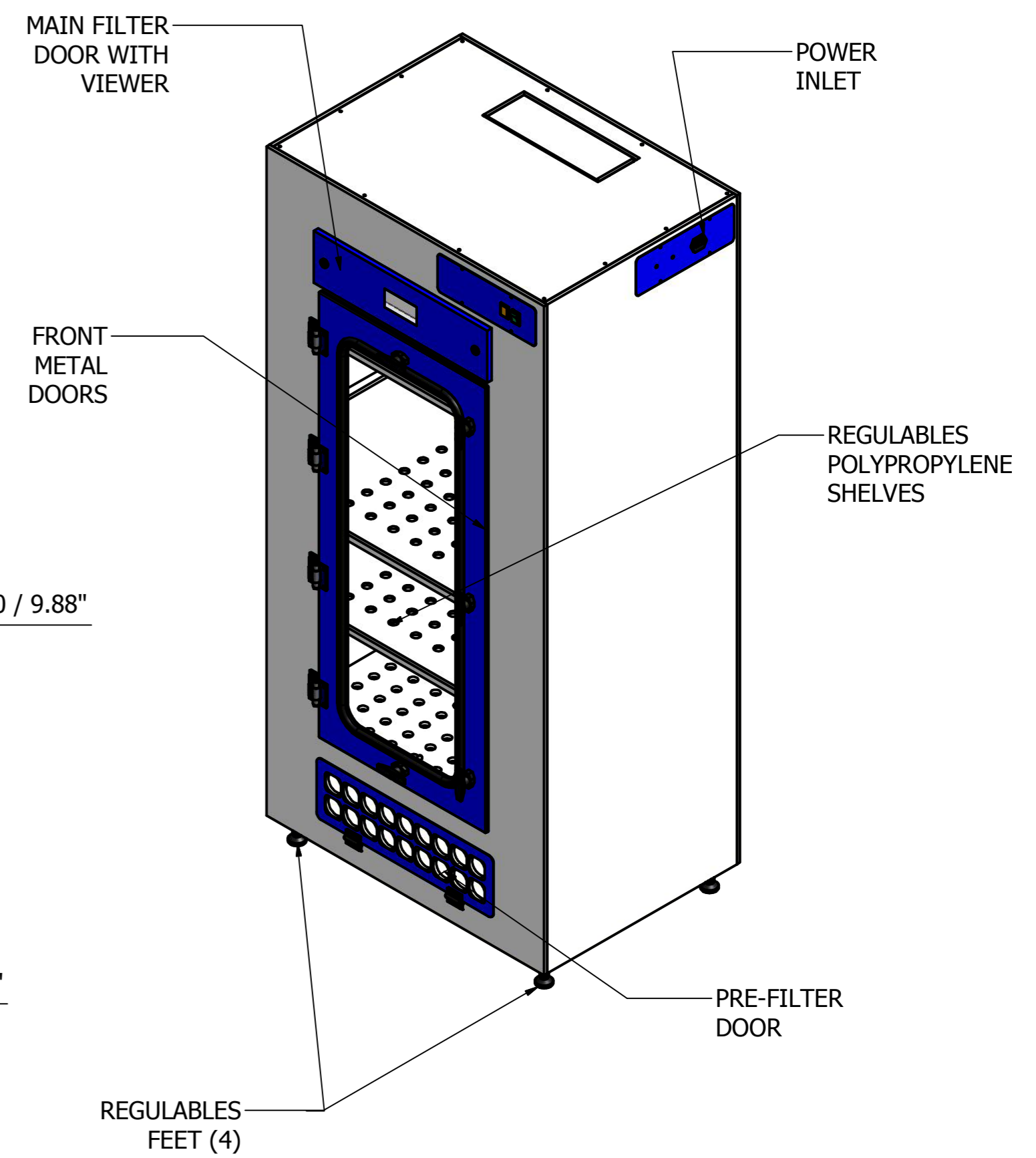

- NOTES:
- 1.0 CONSTRUCTION:
 - 1.1 BODY BUILD IN WELDED PP 3/8".
 - 1.2 FRONT METAL DOOR WITH TEMPERED GLASS.
 - 2.0 REMOVABLE POLYPRO SHELVES IQUAL SPACING BETWEEN SHELVES.
 - 3.0 REGULABLES FEET.
 - 4.0 STANDARD FEATURES APPLIED.

Designed by CFG	Checked by	Approved by	Date 1/13/2014	Date
AIR SCIENCE USA		SAFESTORE 34T		
SC34T1800R12F-GAssem			Edition 2	Sheet 1 / 1