

NEDERMAN FX32 BENCHTOP EXTRACTION ARM ESD

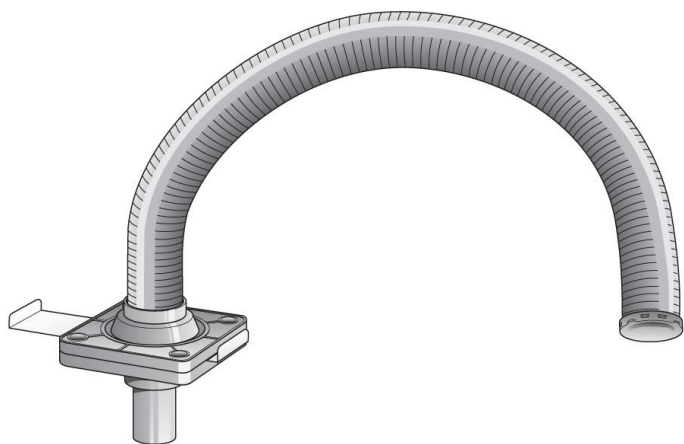

DESCRIPTION

Nederman FX32 Benchtop Extraction Arm ESD is suitable for use in electronic industries, laboratories, schools, etc. Flexible plastic hose with a very good resistancy against solvents, etc. Stays in new position when adjusted. ESD safe. Swivel with 360 degree rotation. This means that the connected ductwork remains firm and does not rotate with the arm. Mounting directly in bench surface or with accessory brackets. Can be mounted both standing and hanging.

TECHNICAL SPECIFICATION

Product Name	Benchtop Extraction Arm FX32 ESD
Installation	(Indoor)
Airflow	20-45 m ³ /h
Extraction Arm Diameter	32 mm
Arm Length	1 m
Noise Level	48 dB(A)

FX32 ARM ESD ACCESSORIES

Accessory	Part Code
Dome hood 1/2 for FX 32 ESD	70371807
Dome hood 1/1 for FX 32 ESD	70371808
Table bracket, 75/50/32 Std/ESD/PP	70371761
Wall bracket FX 32 Std/ESD/PP	70371760

FX32 ARM ESD DIMENSIONS

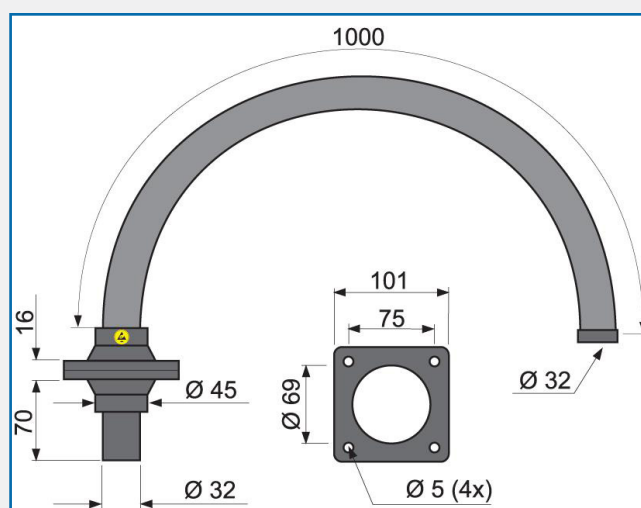

PRESSURE DROP GRAPH

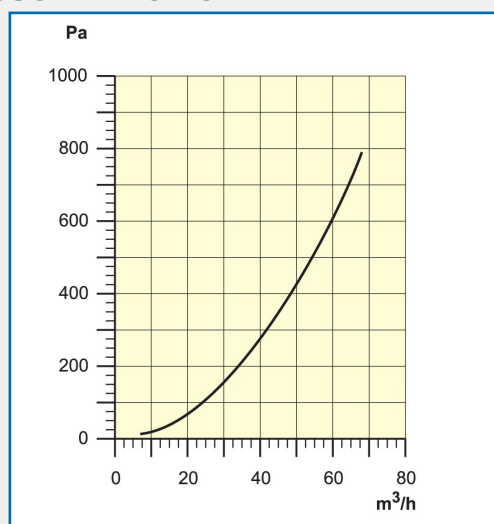

PART CODE/ORDERING TABLE

Item	Part Code
FX32 Arm ESD	70502934

AES OFFER INSTALLATION AND SERVICE SUPPORT FOR ALL EQUIPMENT