

## NEDERMAN FX2 50MM BENCHTOP EXTRACTION ARM

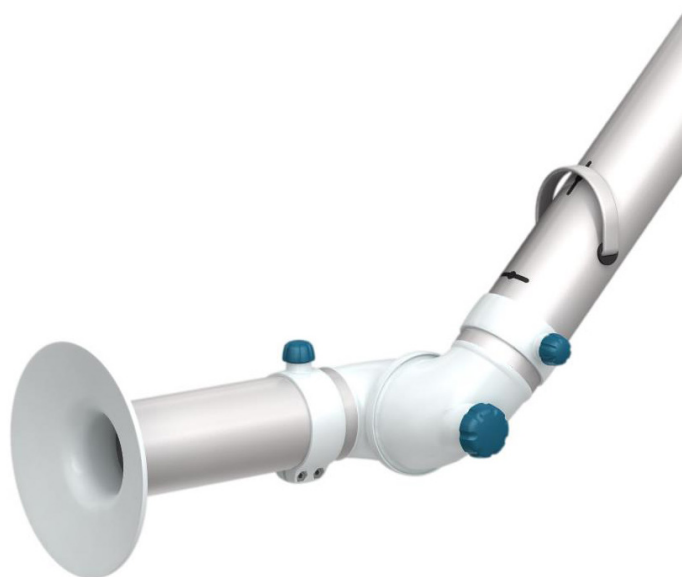

### TECHNICAL SPECIFICATION

Airflow	50-110 m <sup>3</sup> /h
Arm Length	(See diagrams)
Extraction Arm Diameter	50
Installation	(Indoor)
Material	Tubes in anodized aluminium. Joints in PP plastic. Dust connectors in EPDM rubber. Minihood in PP plastic.
Fume Temperature	Max. 70°C
Noise Level	60 dB(A) at 110 m <sup>3</sup> /h

### PRESSURE DROP DIAGRAM

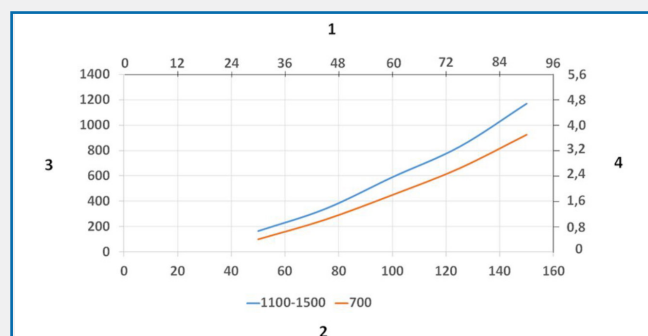

### SOUND LEVEL DIAGRAM

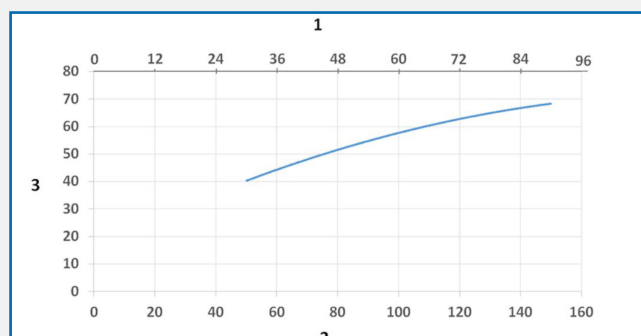

### DESCRIPTION

Nederman FX2 Arms are made of lightweight anodized aluminium sections, with two or three adjustable, composite friction joints. Offering strength and durability combined with easy handling, they can be used in many types of environment.

They are especially suitable for applications where small, flexible and easy-to-use arms are required. A robust and reliable all-round arm for general applications where there is little risk of electrical discharges or attack by aggressive chemicals.

### FEATURES

- Optimal efficiency and low noise provides a safe and quiet working environment.
- Ceilings, walls and floors or fixed to worktops mountings and cut2fit extension profile gives maximum installation flexibility.
- The two outermost arm joints can rotate and swivel through 360°, which gives the unique maneuverability.
- The lean, smooth and aesthetic design allows arms to fit in well in any environment without compromising its durability and reliability.
- Highly integrated products that save customers' time and costs, as well as providing the reliability and functionality to deliver a better performance.

AES OFFER INSTALLATION AND SERVICE SUPPORT FOR ALL EQUIPMENT

# NEDERMAN FX2 50MM BENCHTOP EXTRACTION ARM

## PART CODES

Description	Part Codes
FX2-ORIG-D50-L700-Up/Down-Low	70600144
FX2-ORIG-D50-L700-Up-PLUS	70600244
FX2-ORIG-D50-L700-Up/Down-Through	70600344
FX2-ORIG-D50-L1100-Up-Low	70600444
FX2-ORIG-D50-L1100-Up-PLUS	70600544
FX2-ORIG-D50-L1100-Down-Low	70600644
FX2-ORIG-D50-L1100-Down-Through	70600744
FX2-ORIG-D50-L1500-Up-Low	70600844
FX2-ORIG-D50-L1500-Down-Low	70601044
FX2-ORIG-D50-L1500-Down-Through	70601144

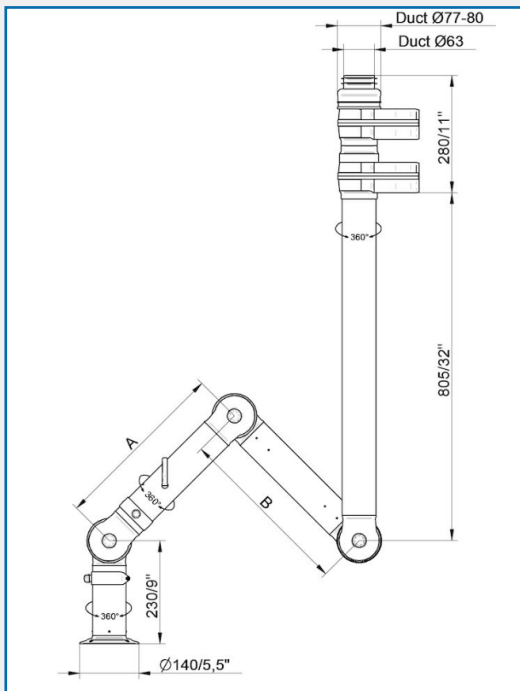

- FX2-ORIG-D50-L700-Up-PLUS
- Part Number: 70600244
- Max. working radius: 630 mm (24.8 inch)
- A: 400 mm (15.7 inch)
- FX2-ORIG-D50-L1100-Up-PLUS
- Part Number: 70600544
- Max. working radius: 1030 mm (40.5 inch)
- A: 400 mm (15.7 inch)
- B: 400 mm (15.7 inch)
- FX2-ORIG-D50-L1500-Up-PLUS
- Part Number: 70600944
- Max. working radius: 1430 mm (56.3 inch)
- A: 500 mm (19.7 inch)
- B: 700 mm (27.6 inch)

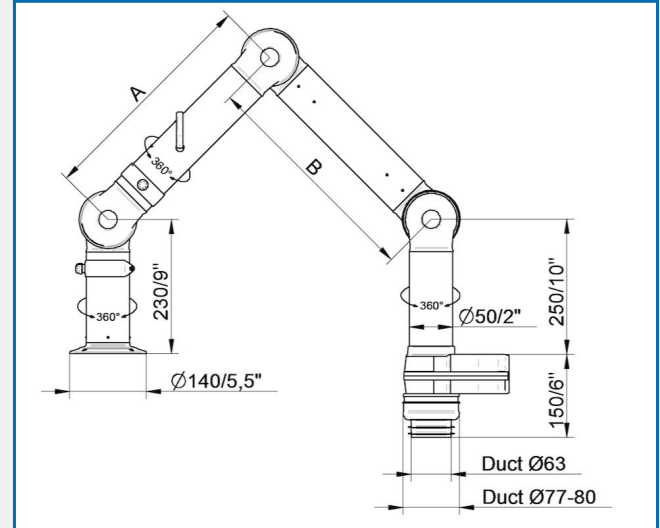

- FX2-ORIG-D50-L700-Up/Down-Low
- Part Number: 70600144
- Max. working radius: 630 mm (24.8 inch)
- A: 400 mm (15.7 inch)
- FX2-ORIG-D50-L1100-Down-Low
- Part Number: 70600644
- Max. working radius: 1030 mm (40.5 inch)
- A: 400 mm (15.7 inch)
- B: 400 mm (15.7 inch)
- FX2-ORIG-D50-L1500-Down-Low
- Part Number: 70601044
- A: 500 mm (19.7 inch)
- B: 700 mm (27.6 inch)

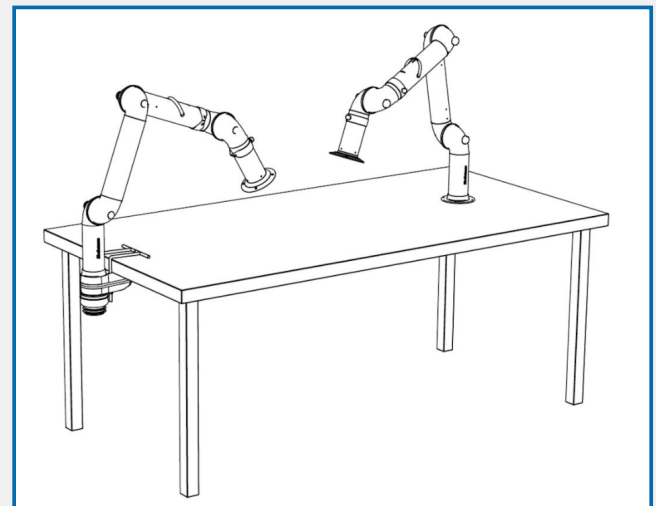

### Bench mounting examples:

- Left: FX2-Down-Low arm with following accessories:
  - FX2-Bench bracket kit-D-50/75/100

Right: FX2-Down-Through arm

AES OFFER INSTALLATION AND SERVICE SUPPORT FOR ALL EQUIPMENT

## NEDERMAN FX2 50MM BENCHTOP EXTRACTION ARM

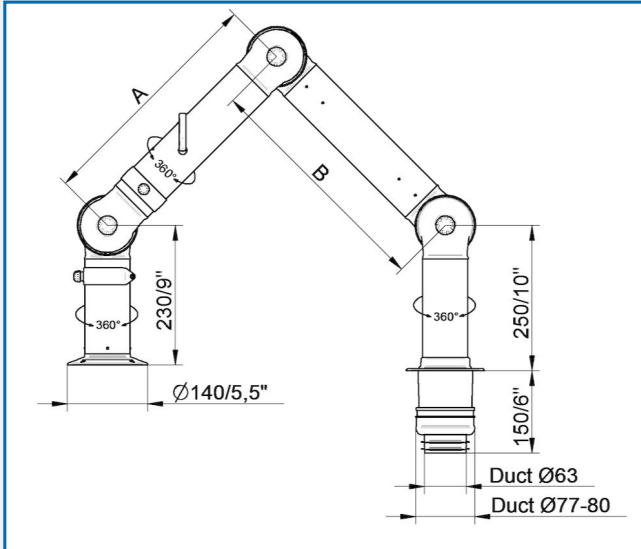

Part Number: 70600344  
Max. working radius: 630 mm (24.8 inch)  
A: 400 mm (15.7 inch)

- FX2-ORIG-D50-L1100-Down-Through
- Part Number: 70600744
- Max. working radius: 1030 mm (40.5 inch)
- A: 400 mm (15.7 inch)
- B: 400 mm (15.7 inch)
- FX2-ORIG-D50-L1500-Down-Through
- Part Number: 70601144
- Max. working radius: 1430 mm (56.3 inch)
- A: 500 mm (19.7 inch)
- B: 700 mm (27.6 inch)

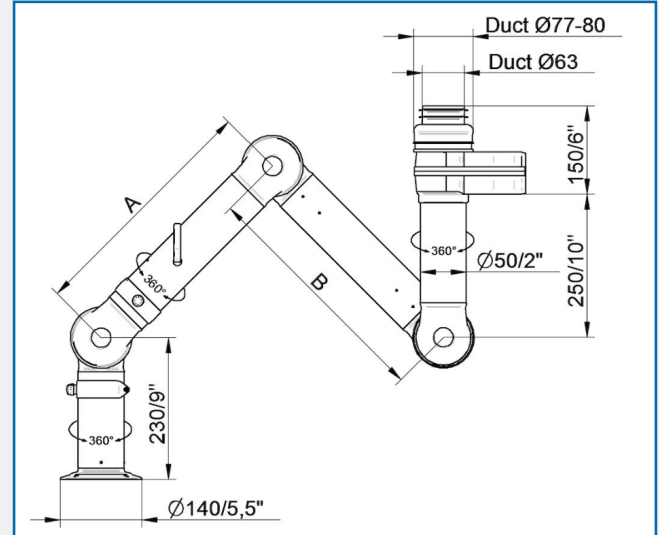

- FX2-ORIG-D50-L700-Up/Down-Low
- Part Number: 70600144
- Max. working radius: 630mm (24.8 inch)
- A: 400 mm (15.7 inch)
- FX2-ORIG-D50-L1100-Up-Low
- Part Number: 70600444
- Max. working radius: 1030mm (40.5 inch)
- A: 400 mm (15.7 inch) - B: 400 mm (15.7 inch)
- FX2-ORIG-D50-L1500-Up-Low
- Part Number: 70600844
- Max. working radius: 1430 mm (56.3 inch)
- A: 500 mm (19.7 inch)
- B: 700 mm (27.6 inch)

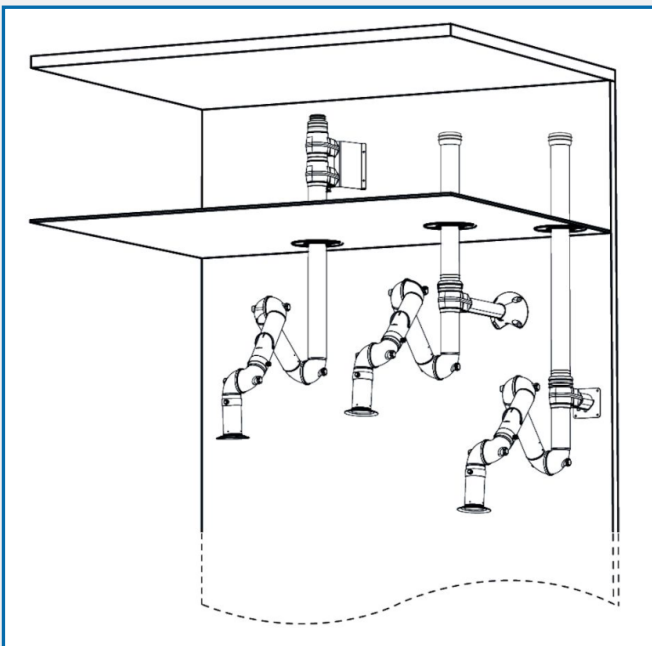

### Wall mounting examples:

Left: FX2-Up-PLUS arm with following accessories:

- FX2-Wall-P BRKT kit-D-50/75/100-L190
- FX2-Ceiling cover plate-PLUS

Middle: FX2-Up-Low arm with following accessories:

- FX2-Bracket kit-D-50/75/100-L500
- FX2-Ceiling cover plate-PLUS / FX2-Alu duct
- FX2-Duct connector-ORIG/CHEM-D75

Right: Up-Low arm with following accessories:

- FX2-Wall BRKT kit-Flat-L190-White
- FX2-Ceiling cover plate-PLUS/FX2-Alu duct
- FX2-Duct connector-ORIG/CHEM-D75

AES OFFER INSTALLATION AND SERVICE SUPPORT FOR ALL EQUIPMENT

## NEDERMAN FX2 50MM BENCHTOP EXTRACTION ARM

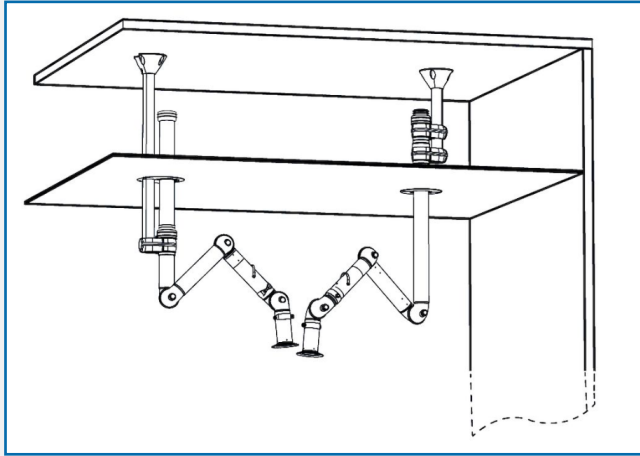

### Ceiling mounting example:

Left: FX2-Up-Low arm with following accessories:

- FX-Classic bracket
- FX-Cut2fit extension-L1100
- FX2-Alu duct
- FX2-Duct connector-ORIG/CHEM-D75
- FX-Ceiling cover plate

Right: FX2-Up-PLUS arm with following accessories:

- FX2-Bracket kit-D-50/75/100-L500
- FX2-Ceiling cover plate-PLUS

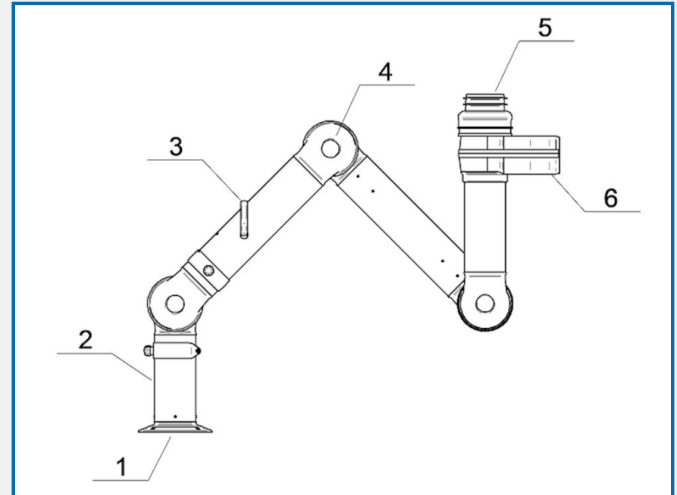

- 1) Flange: PP
- 2) Tubes: Aluminium, anodized 10 µm
- 3) Damper adjustment handle: Aluminium, anodized 10 µm  
Internal spring: Stainless steel  
Damper blade: Conductive TP & PP plastic
- 4) Joints: PP withh glass fibre reinforcement  
Plastic rings: PP with glass reinforcement  
Axial locking rings: PP with glass fibre reinforcement  
Adjustment knobs: PA & EDS plastic  
Threaded shaft inside joints: Stainless Steel
- 5) Duct connector: EPDM Rubber
- 6) Swivel: Aluminium, powder coating  
Rivets: Aluminium  
Bearings swivel: PP plastic with glass fibre reinforcement

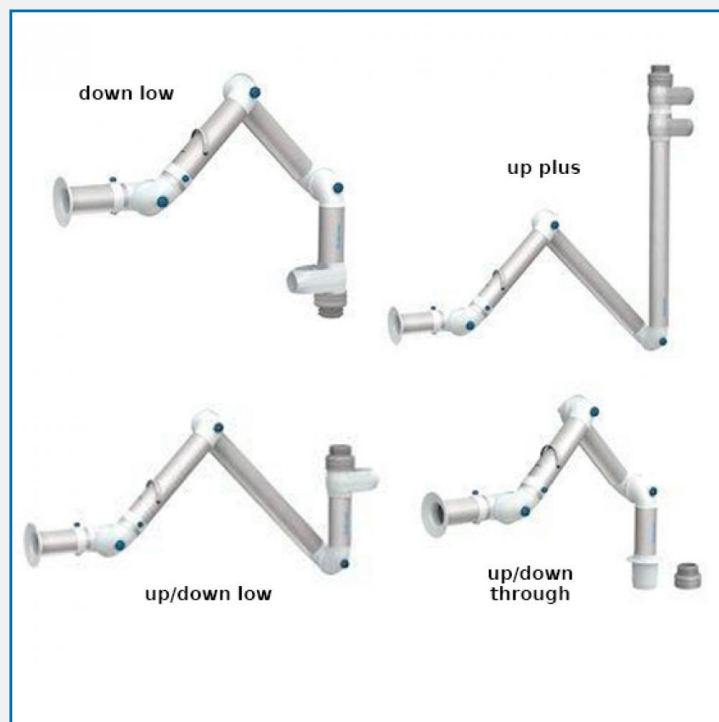

AES OFFER INSTALLATION AND SERVICE SUPPORT FOR ALL EQUIPMENT