

AIRBENCH DF DOWNDRAUGHT BENCH



TECHNICAL SPECIFICATIONS

Power Supply	240v/1ph
Motor	Backward Curved Centrifugal Fan with EC Motor
Noise Level	<60dBA at 1m
Finish (STD)	White powder coat

FEATURES

- Heavy Duty 1.5mm and 2mm steel
- Fully welded and powder coated
- 3mm stainless steel surface, perforated and welded.
- 50kg surface loading
- Various filtration options
- Designed for laboratory environments

APPLICATIONS

- Designed for fume extraction applications where limited space is available and fumes cannot be exhausted to atmosphere.

DESCRIPTION

The AirBench DF range consists of 3 Downflow workstations designed specifically for fume extraction in laboratory or lighter duty environments.

DF units combine the benefits of downdraught extraction with the flexibility of a bench mounted system. Filtration options include specialist carbon blends allowing the capture of a wide range of contaminants. A stainless steel surface protects from more aggressive chemicals while mounting the filters above the workspace avoids filter contamination through spillage.

FILTER OPTIONS

208EA	Standard activated carbon
ACU-L2	Museum Grade - SO ₂ /SO _x /NO ₂
ACMO-L2	Formaldehyde
ACX-L-2	NO ₂ , NO _x , SO ₂ , SO _x , VOC, Diesel
ACSG-L-2	Acid Gases
ACA-L-2	Ammonia and Alkaline



AES OFFER INSTALLATION AND SERVICE SUPPORT FOR ALL EQUIPMENT

AIRBENCH DF DOWNDRAUGHT BENCH

DIMENSIONS

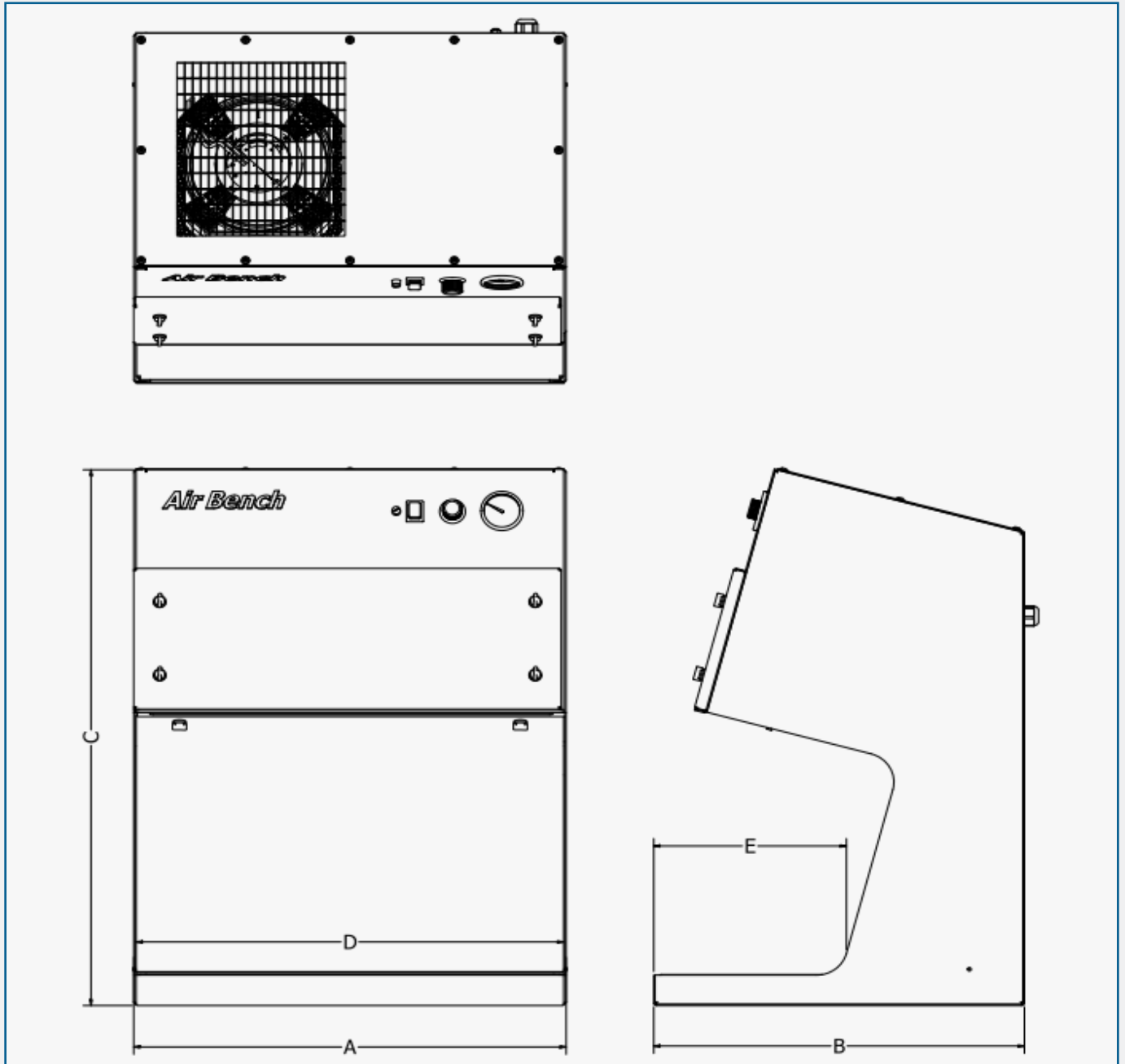

Model	Overall			Ventilated Area		Power	Volume
	Width A	Depth B	Height C	Width D	Depth E	kW	m3/h Nom
DF07	700	600	917	690	300	0.17	400
DF13	1300	600	917	1290	300	0.34	800
DF19	1900	600	917	1890	300	0.51	1200

AES OFFER INSTALLATION AND SERVICE SUPPORT FOR ALL EQUIPMENT

AIRBENCH DF DOWNDRAUGHT BENCH

HOW IT WORKS

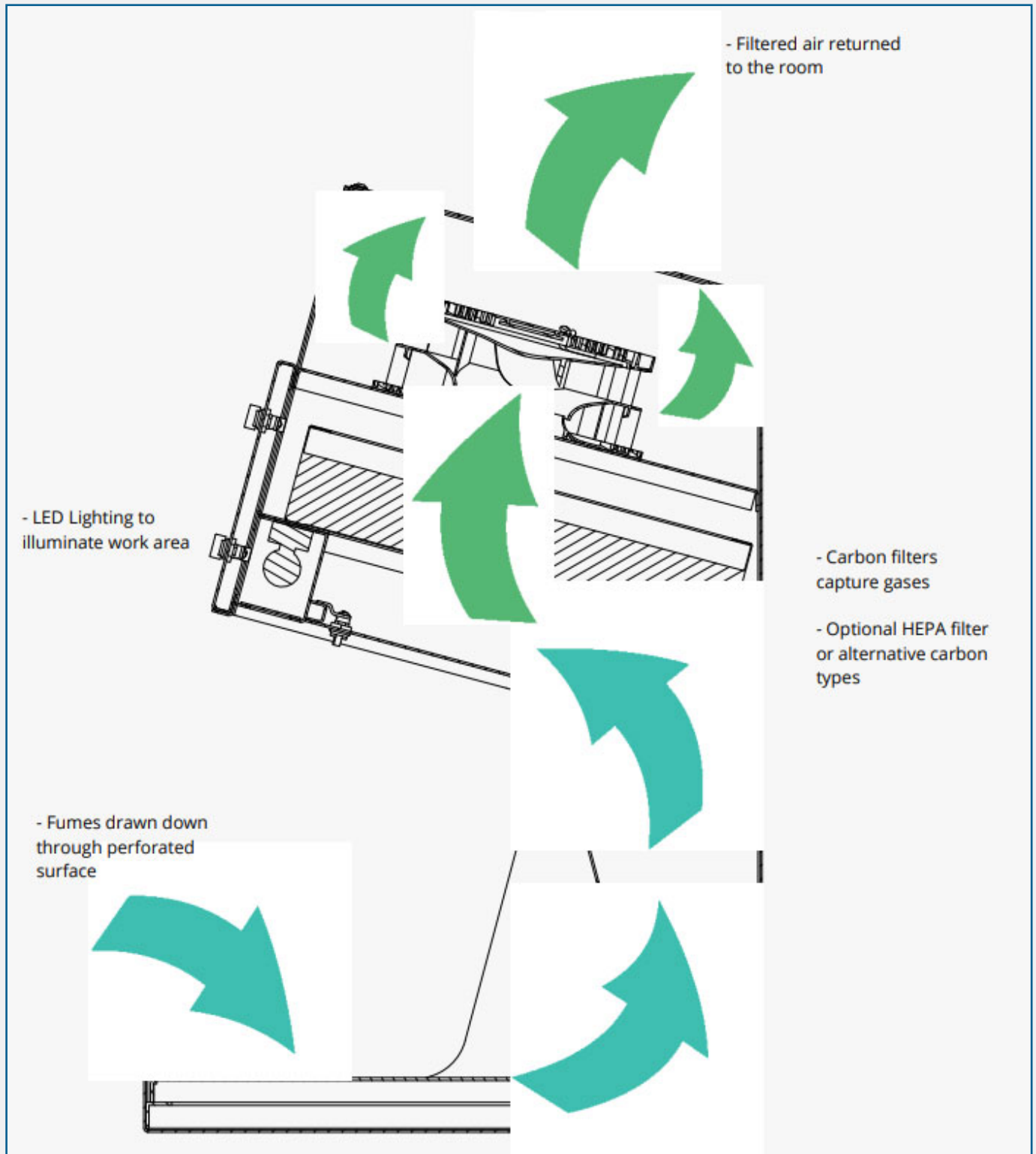

AES OFFER INSTALLATION AND SERVICE SUPPORT FOR ALL EQUIPMENT