

A-MIST10 & A-MIST20 OIL MIST FILTERS



TECHNICAL SPECIFICATION

Model	A-mist10	A-mist20 / A-mist20HP
Max permissible air volume [m ³ /h]	1000	2000
Sound level, 1m in front of filter unit ¹⁾ [dB(A)]	64 ¹⁾	70/72 ¹⁾
Weight (dry filters) [kg]	115	215/220
Available dim. ext. pressure drop [Pa]	< 50	300/500
Filter area, filter 1 (Absolent filter) [m ²]	12.8	14.3 ²⁾
Filter area, filter 2 (Absolent filter) [m ²]	-	12.8 ²⁾
Filter area, filter 3 (HEPA filter) [m ²]	20.4	20.4
Fan Data		
Motor output [kW]	0.55	2.2
Rated current (3-Phase, 400V) [V]	380-420	380-420
Power supply [A]	1.35	4.6
Speed [rpm]	2800	2800

1) Sound absorption in premises=200m², Hemispherical sound propagation.

2) The filter area varies for different applications.

DESCRIPTION

The Absolent type A-mist oil mist filter features one of the most effective systems in the world for cleaning oil mist. A-mist10 and A-mist20 are available with different filter cassettes depending on the application and are designed for air flows up to 1000m³/h respectively 2000m³/h. The filter units are placed adjacent to one or several machines. The A-mist20HP version can even cope with longer duct lengths and thereby higher external pressure drops.

Having the highest possible collecting efficiency, the filtered air becomes so clean that it usually can be returned to the premises. This means less loss of energy and a more balanced ventilation.

Absolent filter units are extremely low maintenance and can usually run for at least one year without requiring a filter change. Moreover, A-mist filter cassettes can usually be washed (does not apply for the HEPA filter. This results in a low total cost of ownership.

The fan, as the only moving component, is placed at the clean-side to minimize wear & tear. The unit has an extremely low noise level for agreeable working conditions.

OPERATION

The filtering process occurs in two (A-mist10) resp. three (A-mist20/HP) stages. The process air passes first through the self-draining Absolent filter cassettes. Here, approximately 90% of the oil mist is arrested. The last stage consists of a HEPA filter, which has a guaranteed and consistent collecting efficiency of 99.99% arresting 0.3 µm dia. particles.

The filter unit has an electronic pressure gauge, A-monitor, which shows the pressure drop over the different filter stages and indicates when a filter cassette is to be changed. Thanks to the continuous draining of the filter cassettes, the unit can be operated without interruptions. The return oil is collected at the bottom of the filter for recycling.

APPLICATIONS

- Grinding (cutting fluid emulsion)
- Turning (cutting fluid emulsion)
- Milling (cutting fluid emulsion)
- Electrical discharge machining
- Machining, using straight oil and moderate loads

AES OFFER INSTALLATION AND SERVICE SUPPORT FOR ALL EQUIPMENT

A-MIST10 & A-MIST20 OIL MIST FILTERS

A-MIST10 DIMENSIONS

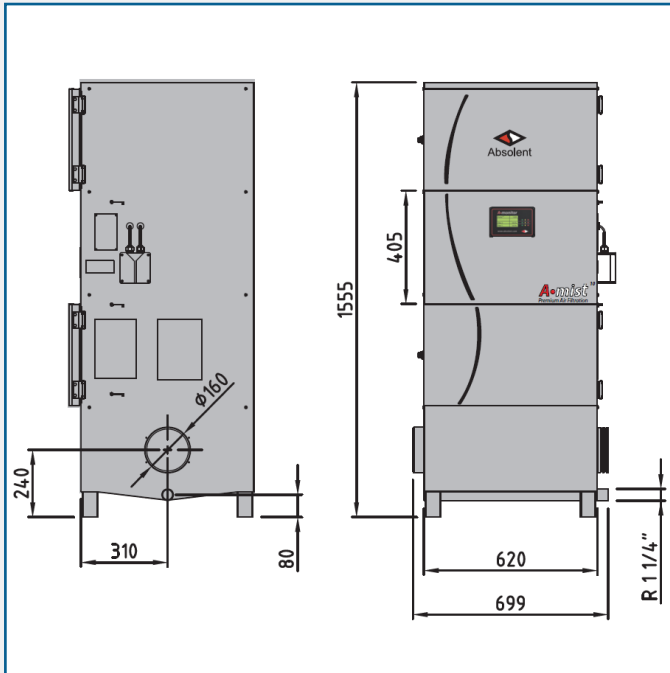

A-MIST20 / A-MIST20HP DIMENSIONS

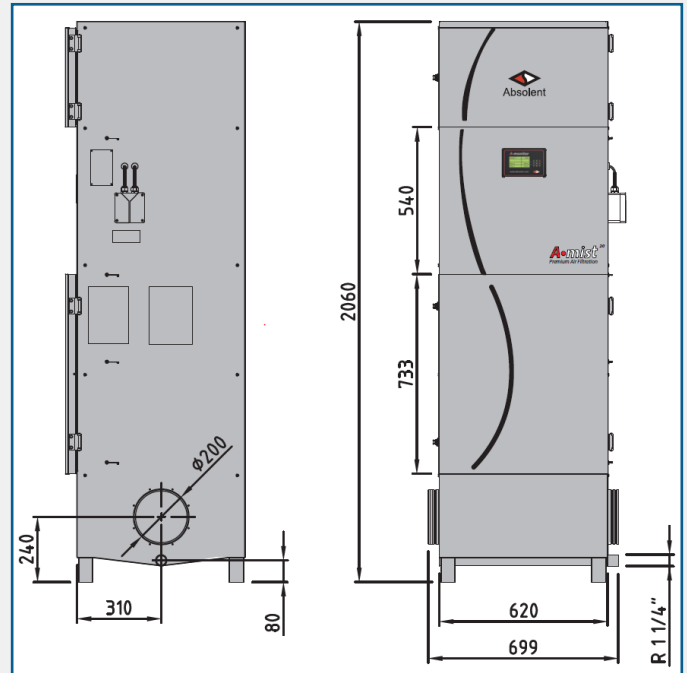

STANDARD EQUIPMENT

- RAL 7035 fine structure (other colours on request!)
- Electronic manometer with the following features:
 - Pressure drop and operation hour meters.
 - Optical indication of filter alarm (LED).
 - Digital output signal for remote supervision.

ACCESSORIES

- Motor starter for fan. Either a manual or protective motor contactor (for automatic or external starting).
- Outlet hood.
- Carbon filter.
- Duct connections for steel or plastic ductwork.
- Extension legs, standard height 400mm.
- Water trap for various connections of the return oil pipe.
- Pump unit for pumping the return oil from the filter.
- Sound insulation (-3 dB).
- Extra outlet silencers (-2 dB).
- Special colours.

Sound level A•mist¹⁰, dB(A)¹⁾

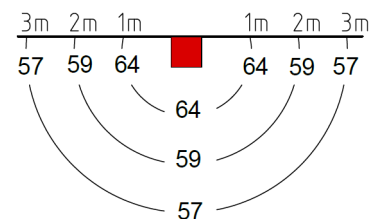

Sound level A•mist²⁰, dB(A)¹⁾

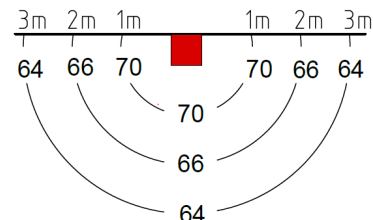

Sound level A•mist^{20HP}, dB(A)¹⁾

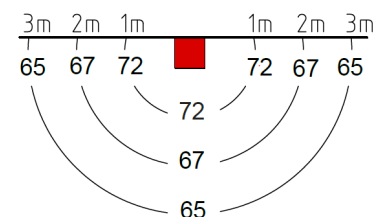

AES OFFER INSTALLATION AND SERVICE SUPPORT FOR ALL EQUIPMENT