

DUSTCONTROL LONG FOODSAFE ESD SUCTION BRUSH



DESCRIPTION

These brushes are made of two pieces, which safely click together - This means that the brush can be sufficiently cleaned via a dishwasher/autoclave sterilisation system.

The brush holders are colour coded in the event that multiple brushes will be used for specific tasks on a food production line.

An anti-static (ESD) construction eliminates the presence of static discharge when in use. A strip of detectable strengthening metal within the brush allows detection from a metal detector on the production line - ensuring maximum safety in the event of a loss of the brush.

These brushes/nozzles are FDA and EC Regulation Certified

OPERATION

The brush slides onto the brush holder before attaching to the suction device or vacuum unit. The two-part system is held in place by means of a clip. It is recommended that the brush be removed from the brush holder when cleaning, as this will ensure that maximum sterilisation is achieved.

The brush and brush holder colour should be chosen in relation to the foodstuff being cleaned, keeping in mind detection via visual appearance.

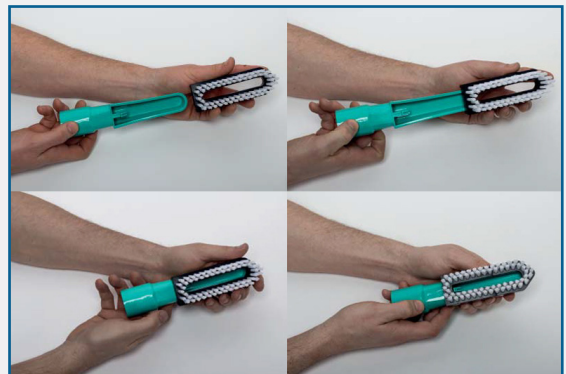

TECHNICAL SPECIFICATION

Visible Bristle Filament Length	25mm
Connection	Ø 38mm
Max Autoclave Cleaning Temp.	121°C
Max Dishwasher Cleaning Temp.	85°C
Max usage Temp. for food usage	40°C
Brush Holder Construction	Polypropylene
Brush Ring Construction	Ultra-high-molecular-weight polyethylene
Bristle Construction	Nylon 66

AES PART NUMBER/ORDERING CODE

Model	Part Code
Brush Holders	77001-01 - Red
	77001-02 - Yellow
	77001-03 - Purple
	77001-04 - Green
	77001-05 - White
Brush Inserts	77901 - White
	77902 - Black

AES OFFER INSTALLATION AND SERVICE SUPPORT FOR ALL EQUIPMENT