

## NEDERMAN NCF 80/20 FAN



### TECHNICAL SPECIFICATION

Protection class	IP 55
Installation	(Outdoor), (Indoor)
Material	Sheet metal, painted grey, RAL 7045
Ambient temperature range	-30 to +40°C
Operating temperature	Max. 60°C
Frequency	50 Hz
No. of phases	3

### DIMENSIONS DRAWING

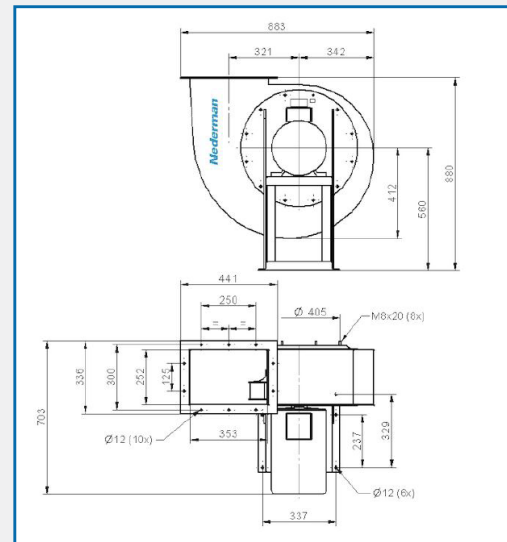

NCF 80/20  
 Duct inlet diameter 400 mm  
 Duct outlet diameter 400 mm

### DESCRIPTION

The Nederman NCF Fans have direct drive motors which means a safe and cost effective operation. Installing an energy efficient NCF fan with other Nederman products saves time and reduces energy costs.

It is a centrifugal fan designed for use in all types of industrial process and ventilation systems, mounted indoor as well as outdoor. The fan is equipped with vibration absorbers as standard.

### PRESSURE DROP GRAPH

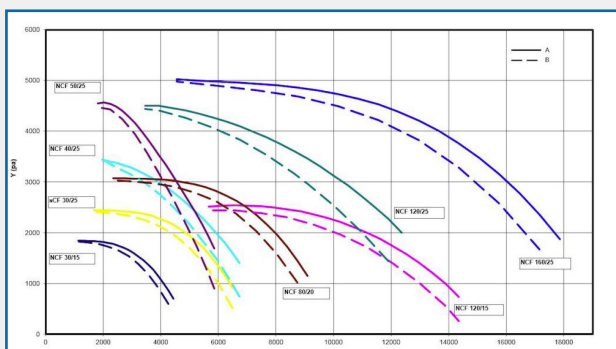

Y= Pressure Drop  
 X= Air flow  
 A= Total pressure  
 B= Static pressure

### PART CODES

Description	Power Voltage	Amperage
Fan NCF 80/20	230/400 V	24.0/13.8 A
Noise Level	Weight	Power
Model		
14550628		

AES OFFER INSTALLATION AND SERVICE SUPPORT FOR ALL EQUIPMENT