

## GEOVENT MHF 400/500 CENTRIFUGAL FAN

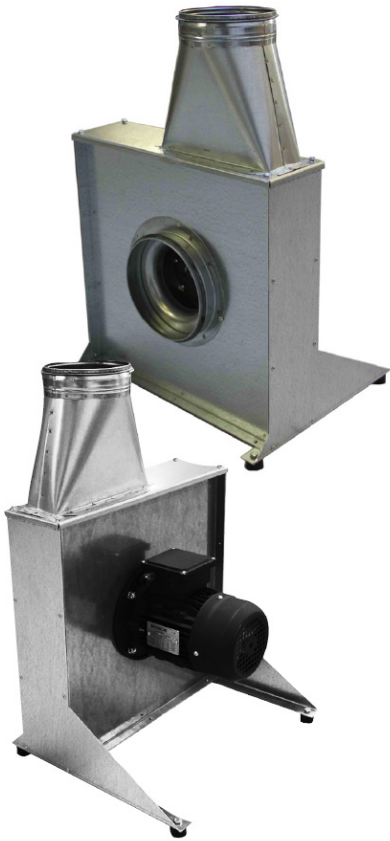

### TECHNICAL SPECIFICATION

Voltage	3 x 400 V / 50 Hz
Max. Negative Pressure	Up to 11.000 Pa using the a frequency converter
Max. Airflow	Up to 4000 m <sup>3</sup> /h MHF-400: Q = 1000 m <sup>3</sup> /h at 1.700Pa MHF-500: Q = 1000 m <sup>3</sup> /h at 3800Pa
Engine	Direct drive with B5 flange motor protection class IP 55
Temperature range	Ambient temperature: +40° C Temperature exhaust air: +80° C
Sound Level	MHF-400 = 86 dB(A) MHF-500 = 93 dB(A)
Finish	Made of hot galvanised sheet metal. All screws and bolts are galvanised. Incl. bear feet with vibration dampers, inlet nozzle with net and chucking equipment for mounting the outlet flange.

### DESCRIPTION

The Geovent MHF 400/500 Centrifugal Fan with backward curved closed B-impeller and direct driven motor.

MHF fan is used for industrial process ventilation. Strong pressure fan, which is suitable for reduced airflow, rates at relatively high pressure.

For example, use MHF in connection with sanding dust. Suitable for PID/constant pressure regulation. The fan is made of galvanised steel and is therefore suitable for outdoor installation on a roof or wall.

For MHF fan Geovent offers a variety of accessories consisting of among others flex connections, mounting brackets, rain shield, motor protection, pressure guard and sound box.

MHF fan comes standard with vibration damping underpin, inlet nozzle with a net and flange for mounting the outlet flange.

### ADDITIONAL PICTURE



AES OFFER INSTALLATION AND SERVICE SUPPORT FOR ALL EQUIPMENT

## GEOVENT MHF 400/500 CENTRIFUGAL FAN

MHF-400 DIMENSIONS DRAWING

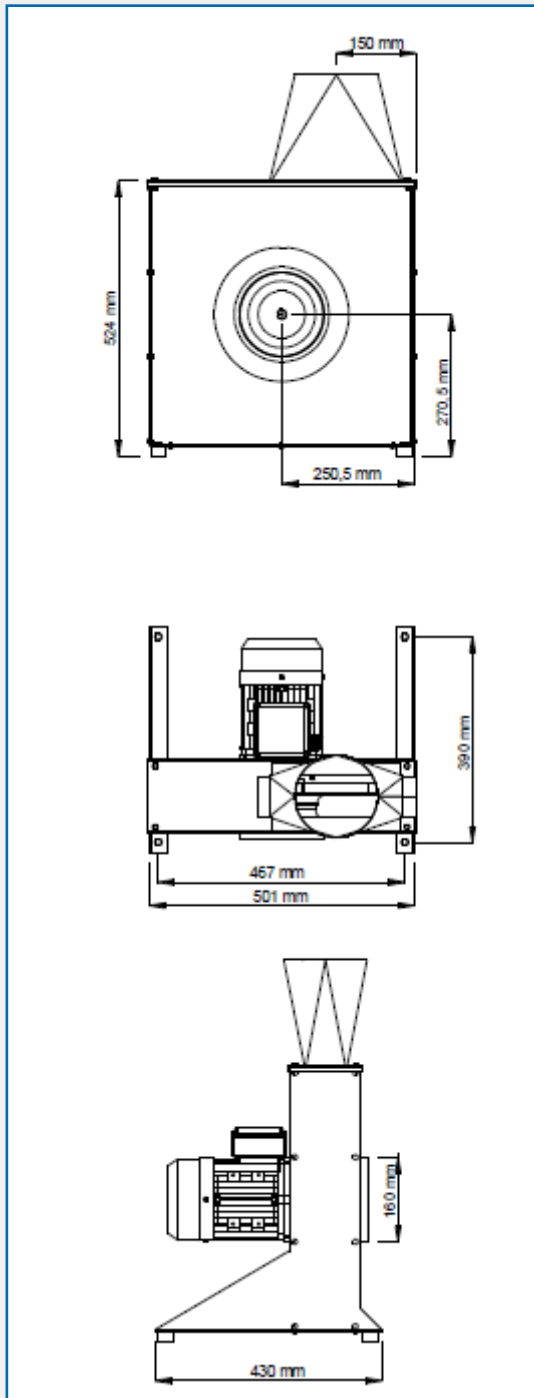

MHF-500 DIMENSIONS DRAWING

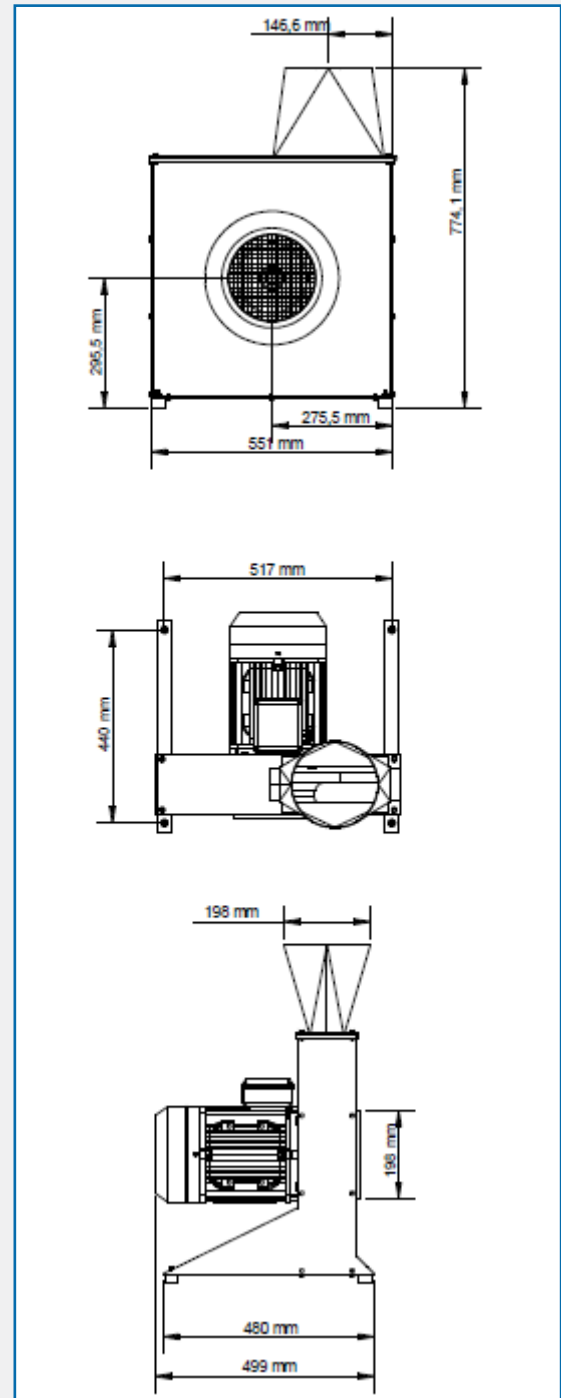

AES OFFER INSTALLATION AND SERVICE SUPPORT FOR ALL EQUIPMENT

## GEOVENT MHF 400/500 CENTRIFUGAL FAN

### PRESSURE DROP

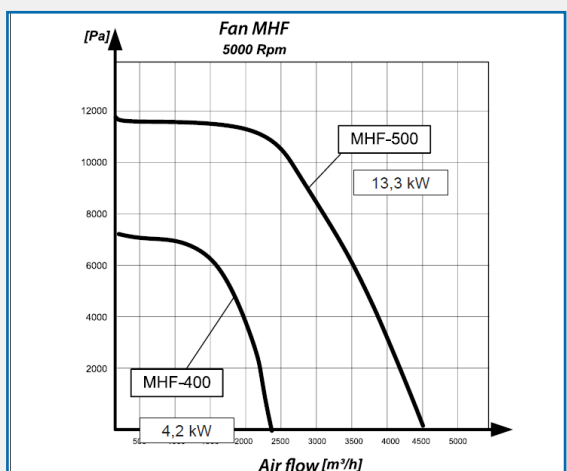
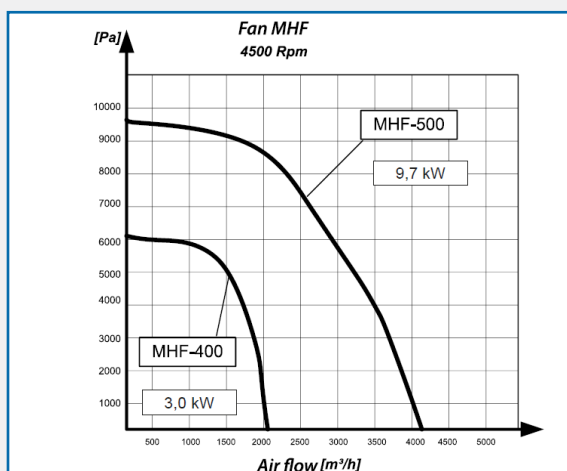
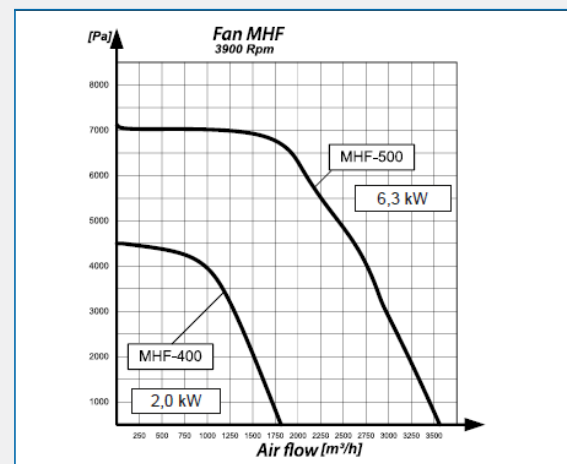
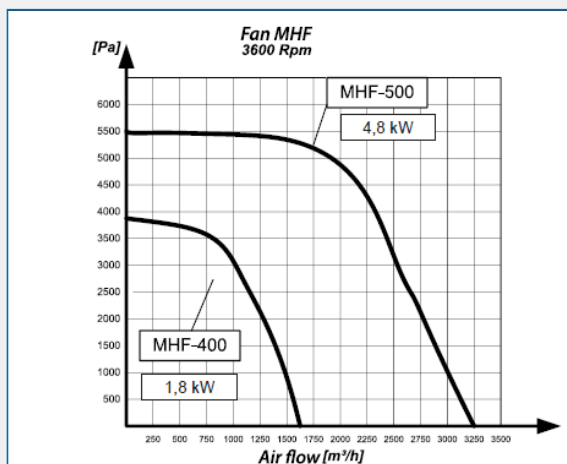
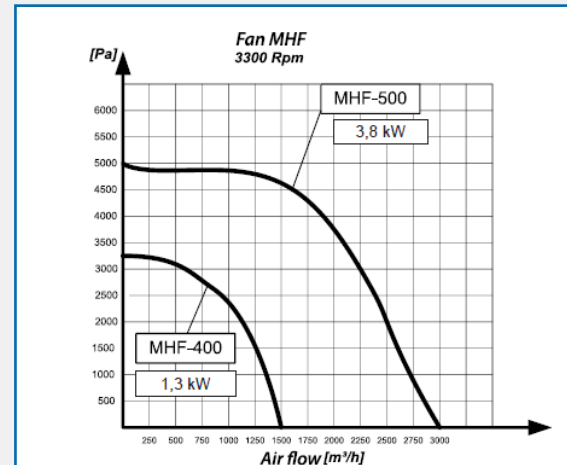
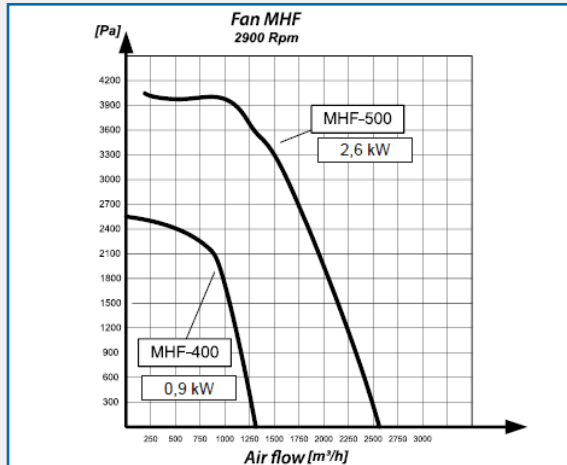

AES OFFER INSTALLATION AND SERVICE SUPPORT FOR ALL EQUIPMENT